

- NOTE(S):
 1. APPLY NSF COMPLIANT GREASE TO ANY O-RING, SEALING JOINTS, AND/OR PIVOTAL POINTS.
 2. APPLY NSF COMPLIANT LOCTITE TO THREADED AREA. 

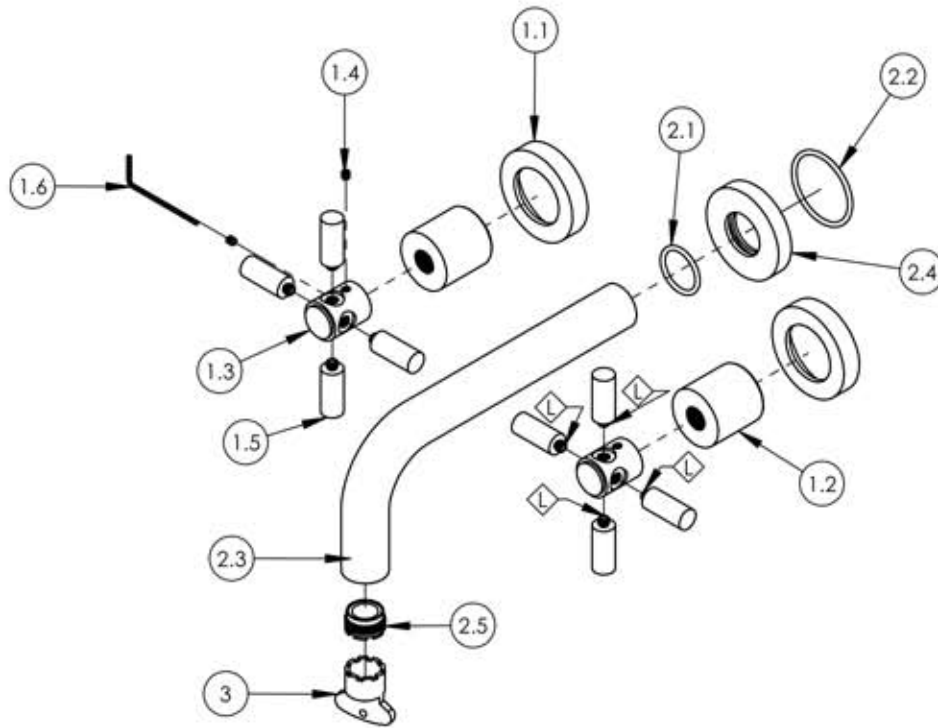

ITEM NO.	PART NUMBER	DESCRIPTION	QTY.
1	3-186/00	TUBULAR CROSS HANDLE FOR DECK TUB, BASIC SERIES	2
1.1	11108/00	ESCUTCHEON LARGE ID FOR RT/PB, BASIC SERIES	1
1.2	11107/00	HUB LARGE FOR RT, BASIC SERIES	1
1.3	P01077/00	STEM, CROSS HANDLE	1
1.4	92008	SET SCREW, CUP POINT 8-32	2
1.5	P01075/00	LOBE, HANDLE CROSS BASIC	4
1.6	P39001	HEX KEY 5/64, FOR 8-32 SET SCREW	1
2	3-418/00	ASSY. 7 1/2" C-C WALL LAV. SPOUT. BASIC	1
2.1	90119	O-RING, 15/16"ID X 1-1/8"OD X 3/32"THK, AS-568-119	1
2.2	90129	O-RING, 1-9/16"ID X 3/32"THK, AS-568-129	1
2.3	P19018/00	WALL LAV SPOUT, BASIC SERIES	1
2.4	P19017/00	ESCUTCHEON, FOR SPOUT	1
2.5	P05024	AERATOR CACHE COIN SLOT, M21.5X1.0 FULL FLOW	1
3	P05025	AERATOR, BASIC KEY, PLASTIC RED	1

ALL	A	UPDATED WITH SUB ASSEMBLIES	10/19/2015	GRE
ZONE	REV.	DESCRIPTION	DATE	APPROVED
REVISIONS				

1261 LOGAN AVENUE
COSTA MESA, CALIFORNIA 92626
PHONE: 714.361.4800
FAX: 714.617.3120

PHYLIRICH®

Defining Luxury Since 1959

PROPRIETARY AND CONFIDENTIAL

THE INFORMATION CONTAINED IN THIS DRAWING IS THE SOLE PROPERTY OF RISS MANUFACTURING. ANY REPRODUCTION IN PART OR AS A WHOLE WITHOUT THE WRITTEN PERMISSION OF RISS MANUFACTURING IS PROHIBITED.

NEXT ASSY	USED ON	FRACTIONS ±1/64"	DECIMALS X.X: ±.1 X.XX: ±.01 X.XXX: ±.005	ANGULAR ±.5°
APPLICATION		NAME	DATE	
MATERIAL		DRAWN	LLO	10/19/2015
FINISH		CHECKED	GRE	

WALL TUB SET, TUBULAR CROSS HANDLE, BASIC SERIES

SIZE	ASM/PRT NO.	REV
A	D1134/00	A
SCALE: 1:4	WEIGHT: lbs.	SHEET 1 OF 2

DO NOT SCALE DRAWING